

电机外形尺寸 Motor Overall Dimension

刹车调速电机 Brake Speed Adjustable Motor **25W**

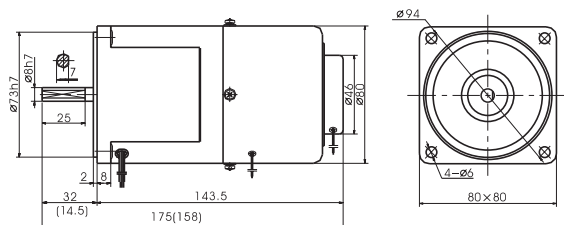

●其中()数字系小齿轮轴电机的数值。●The value in the () is the value of small gear shaft motor.

电机特性表 List of Motor Characteristics

| 电机型号 Model of Motor | | 出力 Output | 电压 Voltage | 频率 Frequency | 极数 Poles | 额定时间 Duty | 调速范围 旋转速度 RPM | 允许力矩 Allowable Torque | | | | 起动转矩 Starting Torque | | 电容容量 / 耐压 Capacitor/Ve |
|------------------------|--------------------------------|--------------|---------------|-----------------|-------------|--------------|---------------------|-----------------------|--------|-----------|--------|-------------------------|--------|---------------------------|
| 光电机 Motor | 带齿轴电机 Motor with gear shaft | W | V | Hz | P | 30 Min | r/min | 1200r/min 时 | | 90r/min 时 | | N.m | kgf.cm | μF/VAC |
| | | | | | | | | N.m | kgf.cm | N.m | kgf.cm | | | |
| 4RK25RA-AM | 4RK25RGN-AM | 25 | 1ph110 | 50 | 4 | 30 Min | 90~1350 | 0.20 | 2.00 | 0.05 | 0.50 | 0.18 | 1.80 | 8.0/250 |
| 4RK25RA-CM | 4RK25RGN-CM | 25 | 1ph220 | 50 | 4 | 30 Min | 90~1350 | 0.20 | 2.00 | 0.05 | 0.50 | 0.18 | 1.80 | 2.2/450 |

●使用电压不同，电容容量也不相同。故应与使用电压相对应，正确使用。●不能正确使用是造成故障的主要原因。订货时，在确认使用电压后，选择正确的型号进行订货。
●The capacitor capacitance will be different under different voltage. A correct capacitor capacitance is required to match the applied voltage. ●Wrong capacitor capacitance is the cause of trouble. You must confirm a correct voltage and select a correct model when your purchase order is placed.

齿轮箱外形尺寸 Overall Dimension of Gearbox

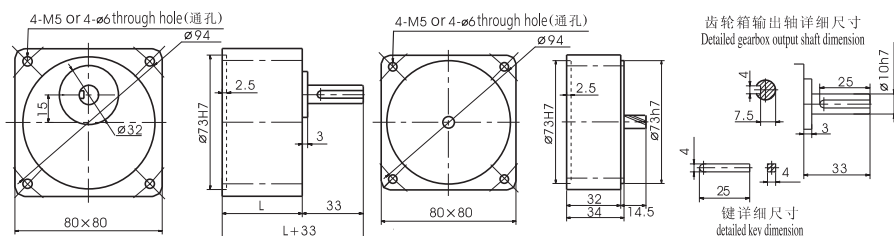

| | 速比 Reduction Ratio | 尺寸 L(mm) | 质量(kg) |
|-------------------------------|--------------------|----------|--------|
| 齿轮箱 Gearbox | 4GN3K-GN18K | 32 | 0.43 |
| | 4GN20K-GN50K | 43.5 | 0.57 |
| | 4GN60K-GN200K | | 0.61 |
| 中间齿轮箱 Intermediate Gearbox | 4GN10X | 32 | 0.43 |
| 电机 Motor | | | 2.05 |

齿轮箱允许力矩 Allowable Torque on Gearbox

齿轮箱型式 Model of Gearbox: 4GN □ K

| 频率 Frequency | 减速比 Reduction Ratio | 3 | 3.6 | 5 | 6 | 7.5 | 9 | 10 | 12.5 | 15 | 18 | 20 | 25 | 30 | 36 | 40 | 50 | 60 | 75 | 90 | 100 | 120 | 150 | |
|--------------|-----------------------------|--------|------|------|------|------|------|------|------|------|------|------|------|------|------|------|------|------|------|------|------|------|------|------|
| 50Hz | 输出轴转速 Output Shaft Speed | r/min | 500 | 417 | 300 | 250 | 200 | 166 | 150 | 120 | 100 | 83 | 75 | 60 | 50 | 41 | 37 | 30 | 25 | 20 | 16 | 15 | 12 | 10 |
| | 允许力矩 Allowable Torque | N.m | 0.52 | 0.63 | 0.87 | 1.05 | 1.31 | 1.57 | 1.74 | 2.19 | 2.62 | 3.15 | 3.15 | 3.94 | 4.72 | 5.66 | 6.29 | 7.12 | 7.84 | 7.84 | 7.84 | 7.84 | 7.84 | 7.84 |
| | | kgf.cm | 5.3 | 6.4 | 8.9 | 10.7 | 13.4 | 16.0 | 17.8 | 22.3 | 26.7 | 32.1 | 32.1 | 40.2 | 48.2 | 57.8 | 64.2 | 72.6 | 80.0 | 80.0 | 80.0 | 80.0 | 80.0 | 80.0 |
| 60Hz | 输出轴转速 Output Shaft Speed | r/min | 600 | 500 | 360 | 300 | 240 | 200 | 180 | 144 | 120 | 100 | 90 | 72 | 60 | 50 | 45 | 36 | 30 | 24 | 20 | 18 | 15 | 12 |
| | 允许力矩 Allowable Torque | N.m | 0.43 | 0.51 | 0.72 | 0.85 | 1.07 | 1.28 | 1.43 | 1.78 | 2.15 | 2.57 | 2.58 | 3.22 | 3.86 | 4.64 | 5.16 | 5.82 | 6.99 | 7.84 | 7.84 | 7.84 | 7.84 | 7.84 |
| | | kgf.cm | 4.4 | 5.2 | 7.3 | 8.7 | 10.9 | 13.1 | 14.6 | 18.2 | 21.9 | 26.2 | 26.3 | 32.9 | 39.4 | 47.3 | 52.6 | 59.4 | 71.3 | 80.0 | 80.0 | 80.0 | 80.0 | 80.0 |

电容器 Capacitor

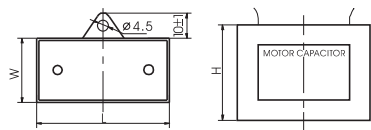

| 电容容量 μF capacity μF | 耐压 Voltage | 长 L±1 | 宽 W±1 | 高 H±1 | 类型 Type |
|-------------------------------------|---------------|----------|----------|----------|------------------|
| 允许偏差 ±5% Allowable Deviation ±5% | V | mm | mm | mm | |
| 2.2 | 450 | 38 | 18 | 28 | 引线式 Down-lead |
| 8.0 | 250 | 47 | 26 | 38 | |

齿轮箱型式 Model of Gearbox: 4GN □ K

| 频率 Frequency | 减速比 Reduction Ratio | 180 | 200 | |
|--------------|-----------------------------|--------|------|------|
| 50Hz | 输出轴转速 Output Shaft Speed | r/min | 8 | 7.5 |
| | 允许力矩 Allowable Torque | N.m | 7.84 | 7.84 |
| | | kgf.cm | 80.0 | 80.0 |
| 60Hz | 输出轴转速 Output Shaft Speed | r/min | 10 | 9 |
| | 允许力矩 Allowable Torque | N.m | 7.84 | 7.84 |
| | | kgf.cm | 80.0 | 80.0 |